

NP1 G2

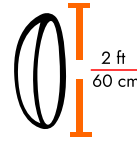

The NP Standard Series by NetPoint offers a cost effective, dual polarized, 4.9-6.4 Ghz, up to 18.64 miles (30km), 2ft parabolic antenna engineered to deliver reliable radio links with a stable 30 dBi gain from 4.9 to 6.4 Ghz.

Designed for U-NII-1, -2A, -2C, -3 and public safety applications.



Reflector



Gain



4.9 - 6.4 GHz

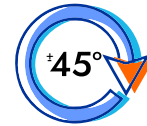

Dual Slant



Pigtails



Lightweight

RADIATION PATTERN

Vertical

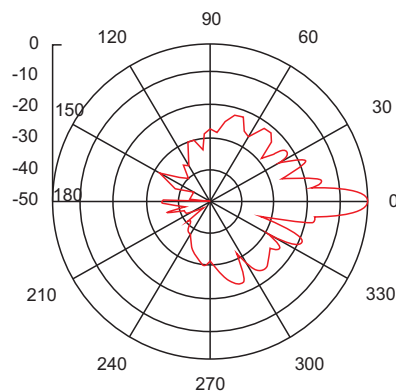

Horizontal

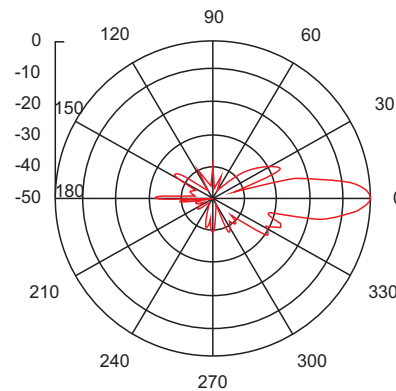

TECHNICAL DRAWING

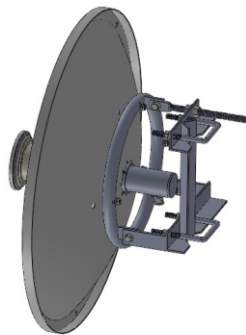

Compatible accessories:
Radome model **RAD60**

FEATURES AND BENEFITS

- Gain of up to 30 dBi with low VSWR and high port isolation across the entire 4.9-6.4 GHz band
- One antenna that covers 5 and 6 Ghz
- Reduced interference with 38 dB minimum front to back
- Simplifies installation on site and guarantees “factory-tested” quality
- Connector type N Female
- Pigtailed of N to RPSMA included in the box for free!!!

ELECTRIC SPECIFICATIONS

Antenna type	Directional parabolic reflector
Frequency	4.9 - 6.4 Ghz
Connector type	Female N
Gain (dBi)	28, 30, 29
	4.9GHz, 5.4GHz and 5.7GHz
VSWR HPOL	<1.5
Beamwidth VPOL	6.0°
Beamwidth HPOL	6.2°
Return loss	11
ISO (dB) Radius	30
F/B (dB)	38
Polarization	Dual slant 45° or 90°

MECHANICAL SPECIFICATIONS

Wind max survival speed (MPH)	124.2 miles with Radome
Azimuth adjustment	+/- 60 degrees
Elevation adjustment (°)	+/- 15 degrees
Mounting Pipe Diameter, Min	1 inch - 25.4mm
Mounting Pipe Diameter, Max	2.750 inch 69.86mm
Operating temperature (C°)	-49 to +140 F° -45 to +60 C°
Connector type	Dual N-Female with pigtailed for RP-SMA
Length of Pig tail	2ft - 600 mm

SHIPPING INFORMATION

Package type	Cardboard
Gross weigh (Kg)	14.3lb - 6.5kg
Dimensions, L x W x H	28.34 x 28.34 x 11.41in 72cm X 72cm X 29cm
Shipping volume	5.29 cu ft 0.14 cu m